

The Antibes

A Three bedroom apartment/home with formal dining room 2009 square feet

This corner apartment/home offers magnificent views. You see the majestic sweep of shoreline as it meets the skyline of the city. You see the ever-changing lake with its many moods and colors. Two full ceramic tile baths (one exclusive to the master bedroom suite), huge walk-in closets, a spacious entry foyer and two enormous terraces make this home a superb investment in luxurious lakefront living.

These are 1969 pre-construction promotional floor-plans and may not be 100% accurate.

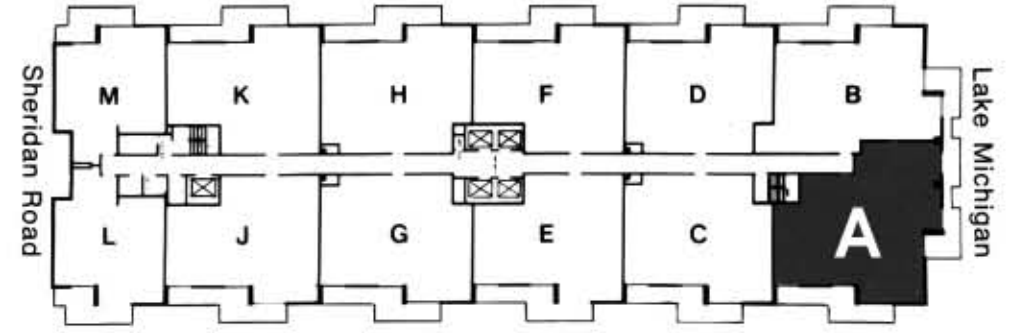

Dimensions are approximate. Plans subject to revisions deemed advisable by builder or architect or required by law. Where materials, brand names or model descriptions are used, the developer reserves the right to provide equipment which supplies equal or superior performance as deemed necessary because of production scheduling, shortages, changes in manufacturers' lines or other reasons.